

THE CRESCENT ADVANTAGE.

TWELVE GREENWAY PLAZA
PREMIER OFFICE SPACE WITH A TELECOMMUNICATIONS ADVANTAGE

TELECOMMUNICATIONS AMENITIES

In-building:

- Voice And High-speed Data
- High Speed Internet
- Captivate Network
- Plug & Play Distribution System
- Cable Television Services
- Fiber From Multiple Providers
- Complete Telecom Diversity
- Fiber Based Telecom Services
- Shared Tenant Services
- Choice Of Nine Providers
- Multiple Points Of Entry
- Riser Closets On Each Floor
- Riser Closets Stacked Vertically

- Controlled & Secured Space
- Plenty Of Vertical Riser Space
- Air-conditioned Equipment Space

Rooftop:

- 180 Degree Coverage Area
- Plenty Of Rooftop Space
- Antenna & Satellite Dish Space
- Easy Access To Roof & Riser Space
- Controlled Radio Room

Power Services:

- Ample Electrical Supply
- Emergency Generator Space

TELECOM PROVIDERS:

AboveNet	877-462-2683
AT&T	800-750-2355
Cogent	877-875-4432
Cypress	713-403-4400
Logix	713-862-2000
Qwest	800-603-6000
tw telecom	713-341-4000
XO (Nextlink)	866-349-0134

CABLE TELEVISION PROVIDER:

Phonoscope	713-272-4600
------------	--------------

This Does Not Represent An Endorsement of These Companies or Their Products by Crescent and May Change Without Notice.

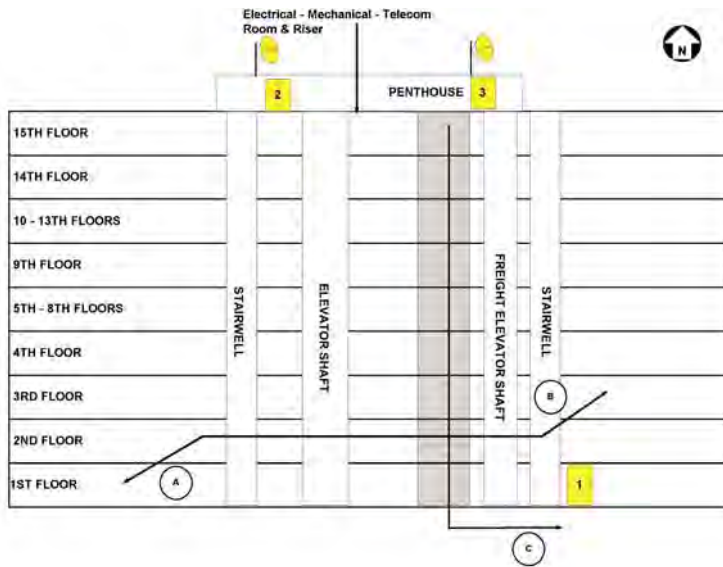

TELECOM EQUIPMENT SPACE

1. Main Telecom Room
2. Available Space
3. Available Space

TELECOM ENTRANCE CONDUITS

- (A) North Entrance Conduits to North Richmond Garage via Sky Bridge across Colquitt St.
- (B) South Entrance Conduits to Eleven Greenway Plaza via Sky bridge across Richmond Ave.
- (C) South Entrance Conduits to Richmond Ave.



For more information contact
Crescent's Telecom Services Group
800-236-7099